

Northwest Community Park Public Art Project

Site

Northwest Community Park, 8575 Blue Mound Road



Narrative Description

Animalis Works, LLC. will create a series of three (3) stainless steel butterfly sculptures with embedded crystal prisms for Northwest Community Park. The numbered map above corresponds with the sculptures and locations listed below. Location 1 will include a small butterfly cluster with two sculptures of similar dimensions off a park pathway. Location 2 will serve as the site for the remaining, and largest, sculpture, which is directly divided by a park pathway. Conceptually, this work is inspired by the monarch butterfly migratory pattern that includes a stop at Northwest Community Park.

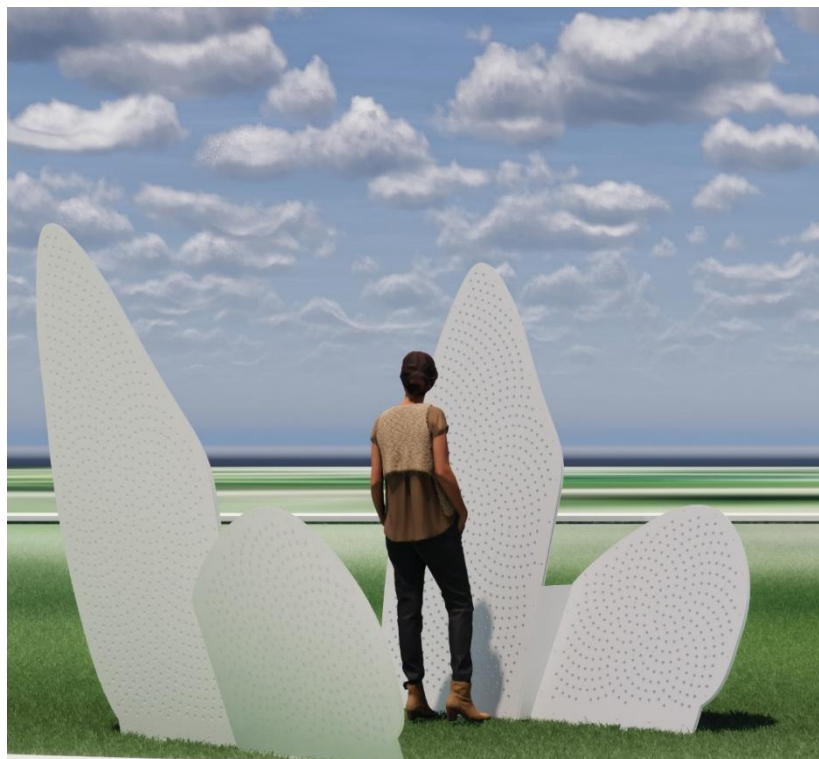

Final Design Images

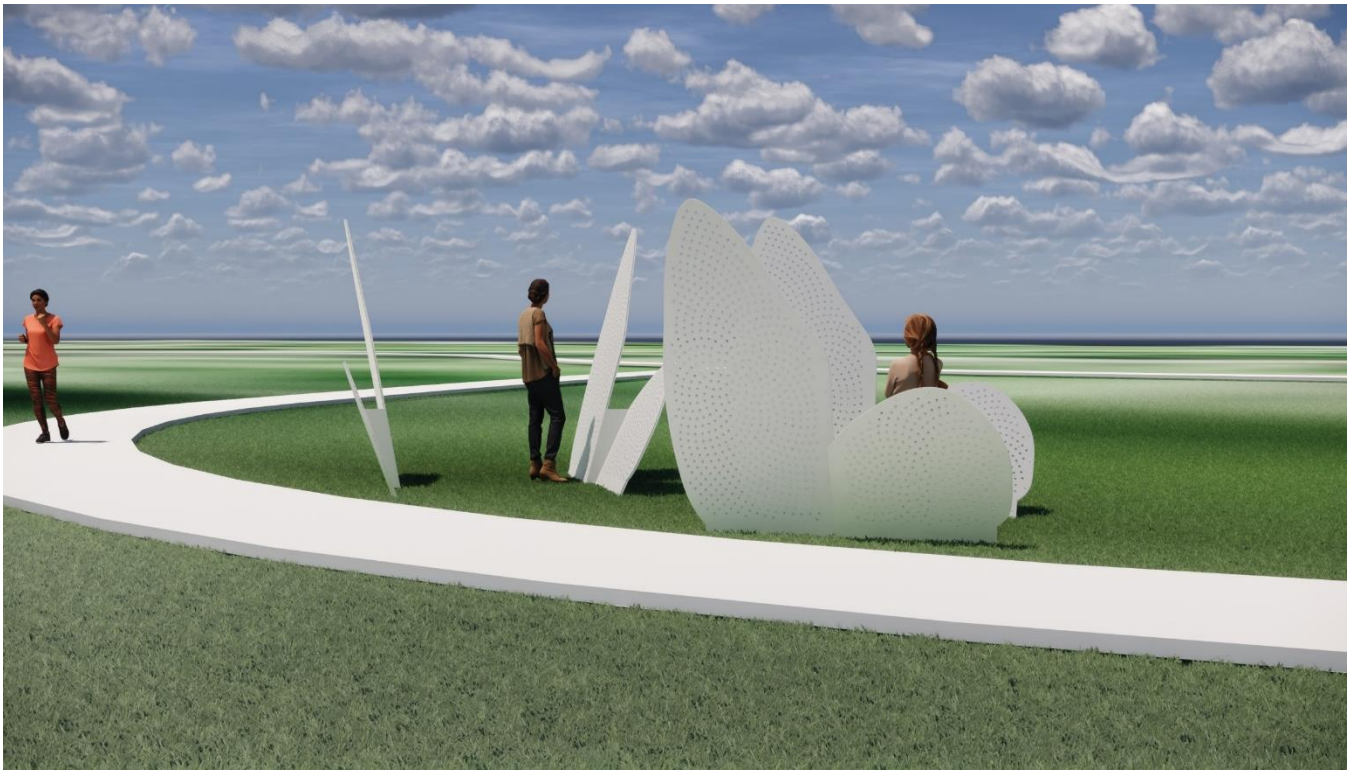

Location 1 (Sculpture Cluster)

Left Sculpture Dimensions: 87.5" (h) x 88.5" (w) x 60" (d)

Right Sculpture Dimensions: 82.25" (h) x 84" (w) x 48" (d)

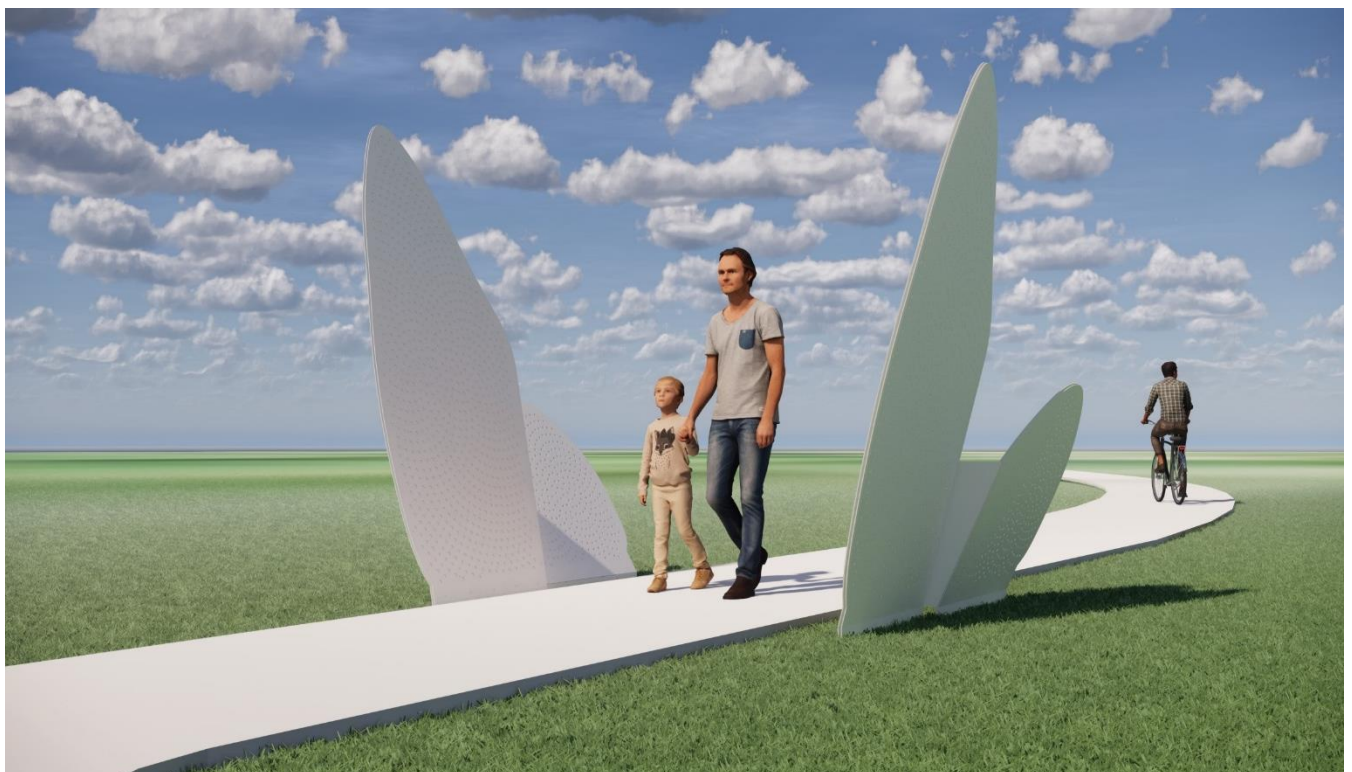

Location 2 (Individual Sculpture)

Dimensions: 93.5" (h) x 94" (w) x 82.5" (d)

Artist Example of Crystal Prism Lighting Effects

