

## Fort Worth Community Art Center Public Art Project

### Site

Fort Worth Community Art Center, 1300 Gendy Street, Fort Worth, Texas, 76107



### Narrative Description

Kris Pierce's artwork will create an outdoor exhibition space for the Fort Worth Community Arts Center (FWCAC). Three concrete sculptural plinths will serve as bases for temporary sculpture exhibitions. As shown in the following map, Plinths 1 and 2 will measure 4' in width x 4' in depth x 1.5' in height, while Plinth 3 will measure 6' in width x 6' in depth x 1.5' in height. Conceptually, this work is inspired by the alphabet designed by FWCAC principal designer Herbert Bayer and is intended to honor the rich modernist architectural history present in Fort Worth's Cultural District.

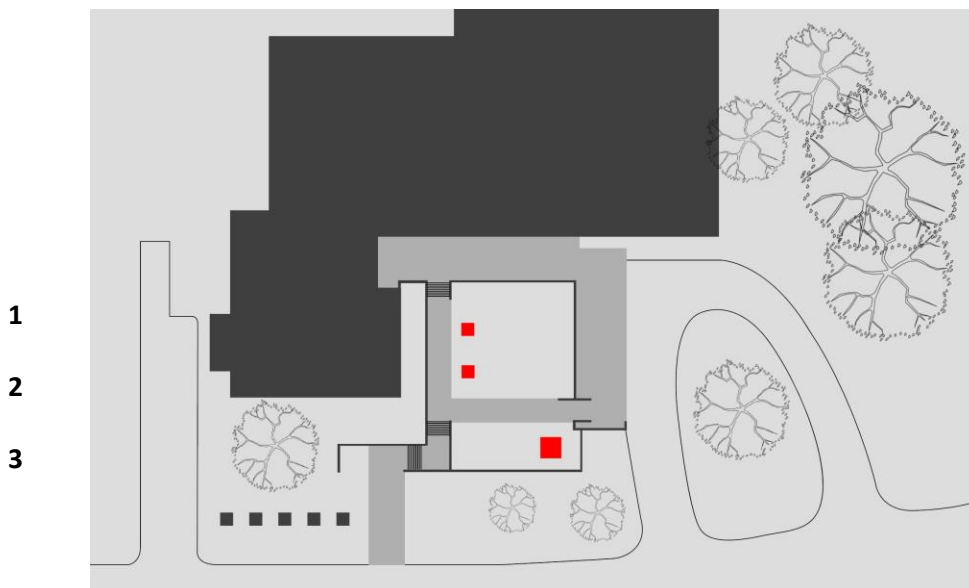

**Final Design Images**

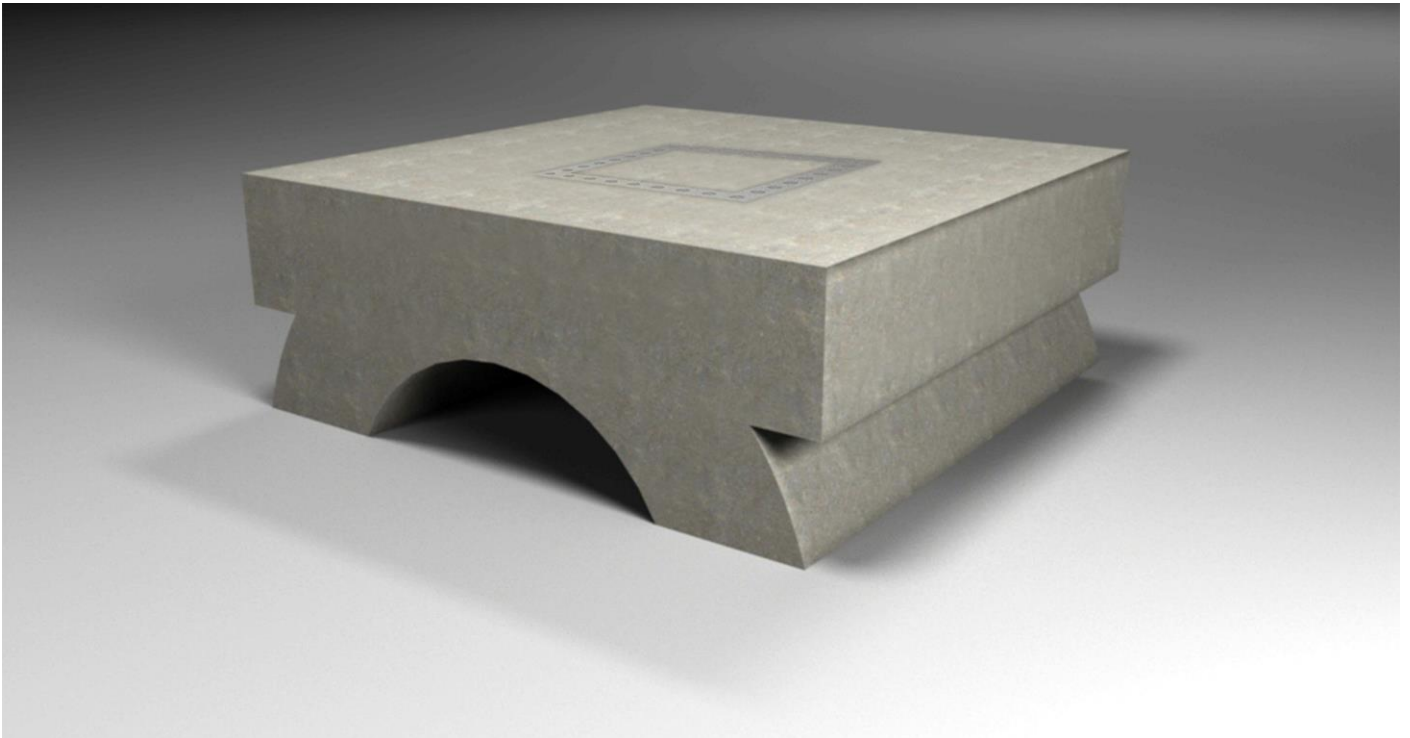

1. Concrete Sculptural Plinth (4' in width x 4' in depth x 1.5' in height)



2. Concrete Sculptural Plinth (4' in width x 4' in depth x 1.5' in height)



3. Concrete Sculptural Plinth (6' in width x 6' in depth x 1.5' in height)