

# Project Case # AX-12-006

Exhibit A

Property Subject to Development Agreement

Approximately 34.02 acres

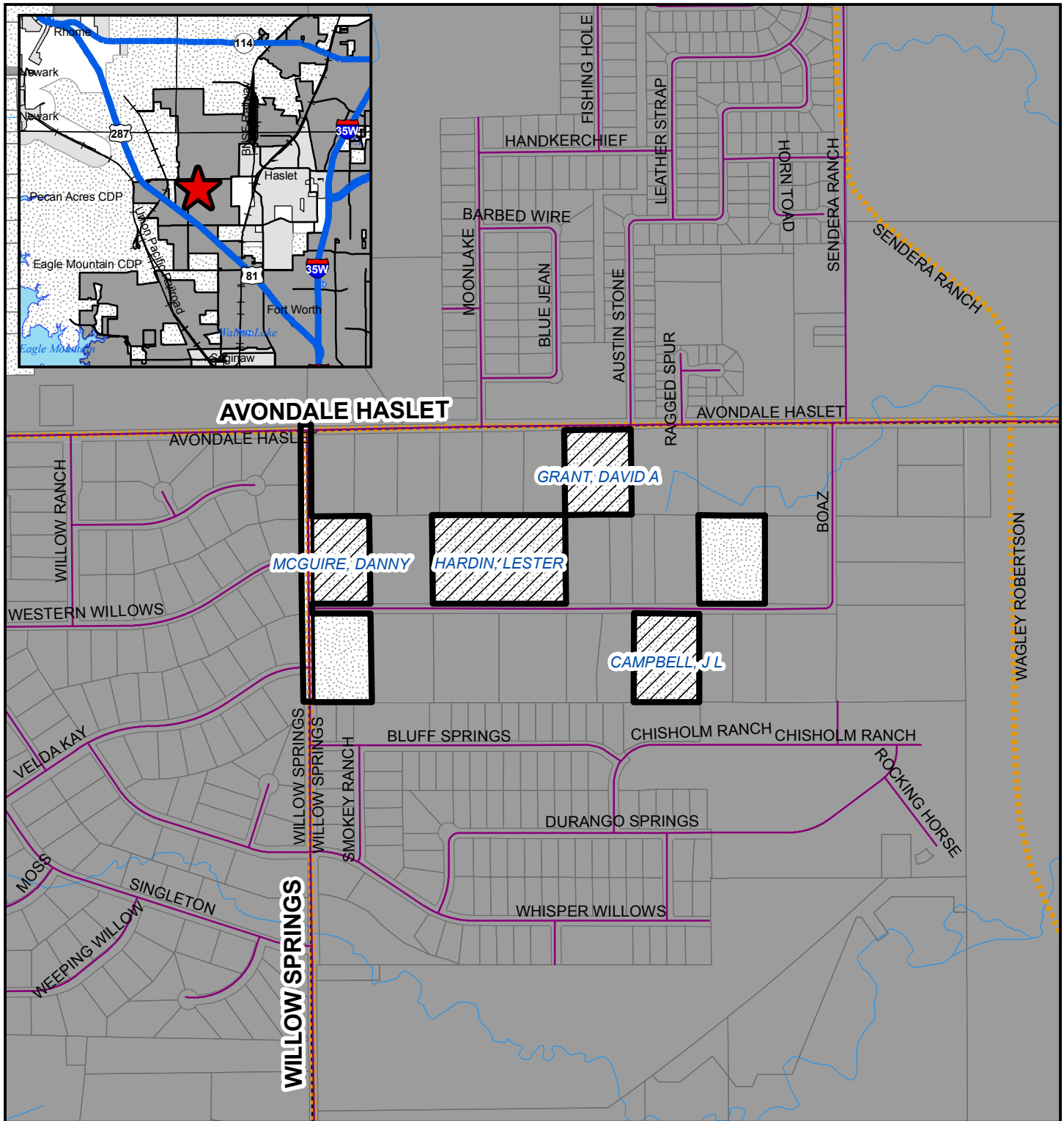

1:10,000

- Property Subject to Development Agreement
- Proposed Annexation Area (9-1) (Approx. 34.02 Acres)
- County Boundaries
- Parcels
- Fort Worth City Limits
- Fort Worth Extraterritorial Jurisdiction

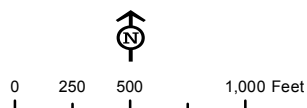

Planning & Development Department  
4/04/2018

COPYRIGHT 2018 CITY OF FORT WORTH UNAUTHORIZED REPRODUCTION IS A VIOLATION OF APPLICABLE LAWS. THIS DATA IS TO BE USED FOR A GRAPHICAL REPRESENTATION ONLY. THE ACCURACY IS NOT TO BE TAKEN / USED AS DATA PRODUCED FOR ENGINEERING PURPOSES OR BY A REGISTERED PROFESSIONAL LAND SURVEYOR. THE CITY OF FORT WORTH ASSUMES NO RESPONSIBILITY FOR THE ACCURACY OF SAID DATA.